

# DDC-16

**DISK TIP ÇEK VANA**  
DISC CHECK VALVE

**DUYAR**

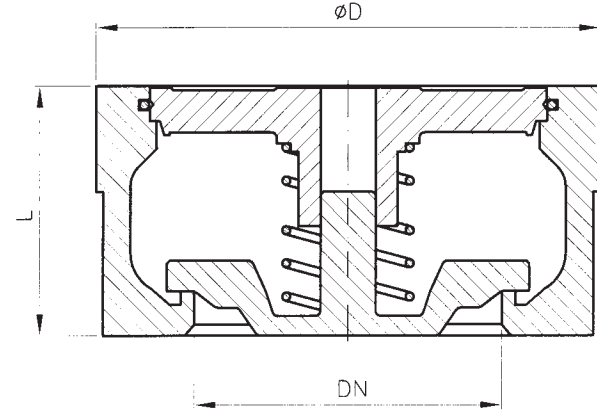
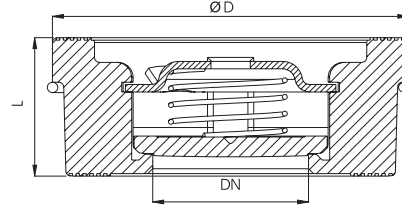

PN 16  
DIN 3202/2-K4  
ISO 5752  
DIN 2501  
DN 15 ... DN 200

ANMA ÇAPI NOMINAL DIAMETER		DN	15	20	25	32	40	50	65	80	100	125	150	200	
MIN. AÇMA BASINCI (mbar) MIN. OPENING PRESSURE	Yaylı With Spring	Akış Yönü / Flow Direction ↔	21										22	23.5	24
			↓	17	18.3	16.3	16.2	16.1	15	13.7	12.5	12	13	14.5	
	Yaysız Withouth Spring	↓		23			24	25		26	26.5	30	32.5	35	
			↓	2.6		3.9	4	4.2	5.1	5.6	7.4	15	17	18.5	

UYGULAMALAR	APPLICATIONS
<ul style="list-style-type: none"> <li>• Sıcak su ve soğuk su sistemleri</li> <li>• Sıvı yakıt sistemleri</li> <li>• Basıncılı hava sistemleri</li> <li>• Asit ve alkali özelliği bulunmayan akışkanlar</li> </ul>	<ul style="list-style-type: none"> <li>• Hot and cold water</li> <li>• Liquid fuel systems</li> <li>• Pressurized air</li> <li>• Fluid excluding acid &amp; flammable fluids</li> </ul>

Anma Çapı Nominal Diameter	DN	15	20	25	32	40	50	65	80	100	125	150	200
Vana Boyutları Valve Dimensions DIN 3202 / 3-K4	ØD	40	47	56	72	82	95	115	132	152	184	209	264
	ØD	15	20	25	31.5	39	48	64	74	89	112	132	175
	L	16	19	22	28	32	40	46	50	60	90	106	140
Ağırlık / Weight	Kg.	0,094	0,134	0,202	0,458	0,620	0,976	1,360	2,078	3,030	6,80	10,00	20,00

PARÇA ADI / PART NAME	MALZEME ÖZELLİKLERİ / MATERIALS		
	DN	15...100	125 / 150 / 200
GÖVDE BODY		DÖVME PİRİNÇ BRASS MESSING	GGG 50
KLAVUZ DISC GUIDE		SS	GGG 50
KLAPE DISC		SS	GGG 50
YAYLAR SPRINGS		SS	SS

**DISK TIP ÇEK VANA**

**DDC-16**